



# Leistritz

## TWIN TELESCOPIC HOLELESS HYDRAULIC ELEVATOR PACKAGES

The Twin Telescopic holeless elevator design from Leistritz eliminates the uncertainty of an in-ground cylinder and inconvenience of longer installation times and expense caused by drilling holes. The Leistritz telescopic hydraulic cylinders sit on the pit floor, where they can be easily inspected and maintained, and where they remain safe from oil leaks and corrosion.

### *Each Leistritz Holeless Hydraulic Elevator Package contains:*



- Hydraulic cylinders with honed pistons;
- Submersible power unit incorporating a low pulsation screw pump, oversized submersible motor, and a muffler that eliminates the pulsation of pressurized oil for a smoother and quieter ride;
- Car sling package with guide rails, brackets, platform, toeguard, guide shoes, buffers, limit switches, cam, and all necessary hardware;
- Manual of shop and field installation drawings.

Each component is manufactured to exacting quality standards, and rigorously inspected at Leistritz before shipment.

The versatility of the Twin Telescopic design has made it the most popular package we offer. It has proven to be excellent for either passenger, service or freight applications. Standard configurations are described on the following pages.



# TWIN DIRECT/TELESCOPIC PASSENGER/SERVICE

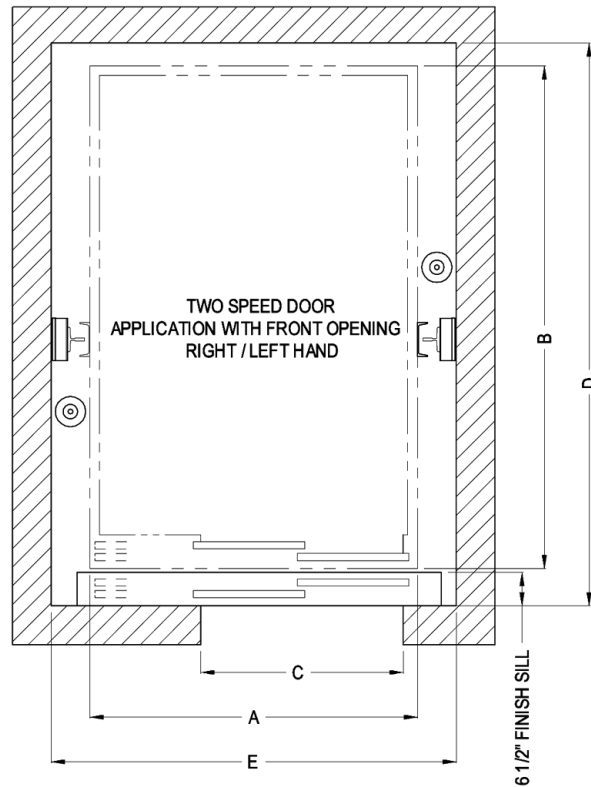
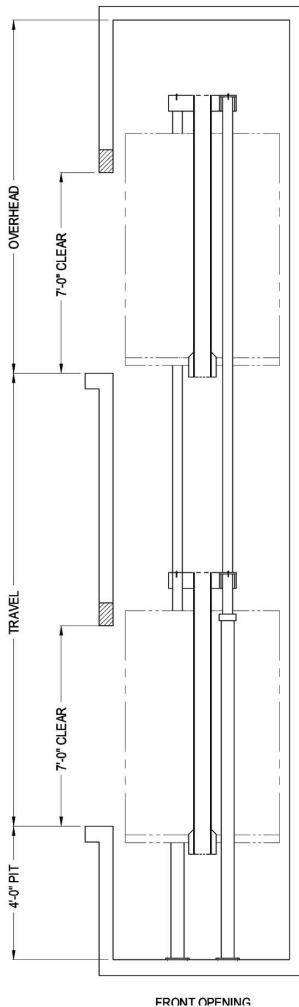

## SPECIFICATIONS: TWIN DIRECT/TELESCOPIC PASSENGER/SERVICE

Type	Twin Direct/Telescopic Passenger/Service Front Opening		
Service	Passenger/Service		
Speed	80 FPM, 100 FPM, 125 FPM, 150 FPM		
Capacity	4000 lb	4500 lb	5000 lb
Clear Car Size			
W x D	5'-8" x 7'-6"	5'-8" x 8'-0"	5'-8" x 8'-8"
A	6'-0"	6'-0"	6'-0"
B	8'-4"	8'-10"	9'-5"
C	4'-0"	4'-0"	4'-0"
D	9'-2"	9'-8"	10'-2"
E	Travel and capacity dependent		
Pit	4'-0" Standard		
Overhead	Travel dependent, consult Leistrizt engineering with questions.		
Machine Room	7'-0" x 5'-0" x 7'-6" Machine room may vary. Consult Leistrizt engineering with questions.		
Entrance Types	Two Speed Door (Left or Right)		
Travel	Up to 30 ft., consult Leistrizt engineering for your application.		

# TWIN DIRECT/TELESCOPIC PASSENGER/SERVICE

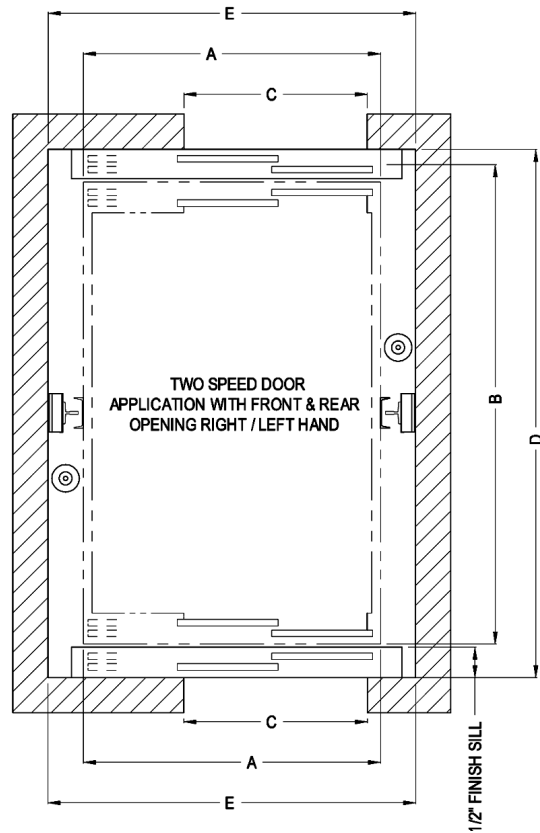
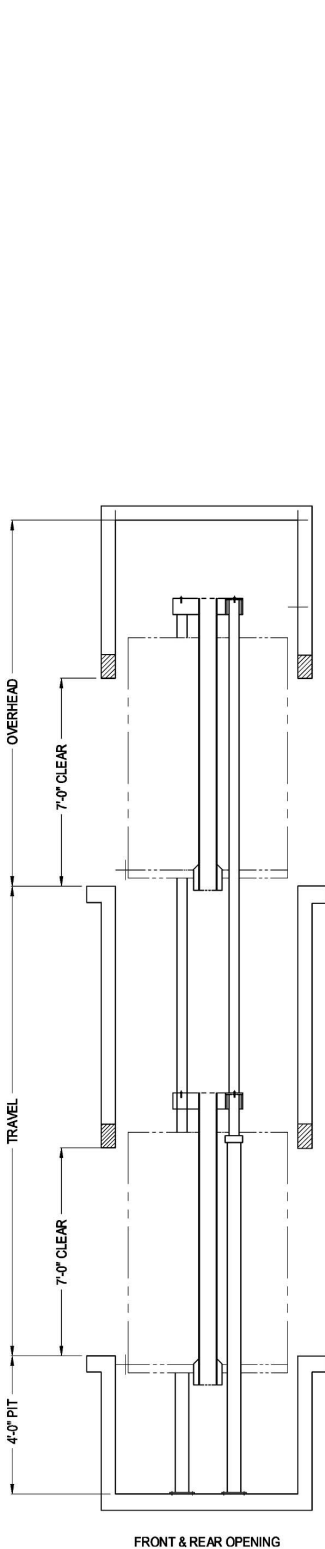

## SPECIFICATIONS: TWIN DIRECT/TELESCOPIC PASSENGER/SERVICE

Type	Twin Direct/Telescopic Passenger/Service Front & Rear Opening		
Service	Passenger/Service		
Speed	80 FPM, 100 FPM, 125 FPM, 150 FPM		
Capacity	4000 lb	4500 lb	5000 lb
Clear Car Size			
W x D	5'-8" x 7'-6"	5'-8" x 8'-0"	5'-8" x 8'-8"
A	6'-0"	6'-0"	6'-0"
B	8'-11 1/2"	9'-5 1/2"	10'-1 1/2"
C	4'-0"	4'-0"	4'-0"
D	10'-3"	10'-9"	11'-5"
E	Travel and capacity dependent		
Pit	4'-0" Standard		
Overhead	Travel dependent, consult Leistriz engineering with questions.		
Machine Room	7'-0" x 5'-0" x 7'-6"		
	Machine room may vary. Consult Leistriz engineering with questions.		
Entrance Types	Two Speed Door (Left or Right)		
Travel	Up to 30 ft., consult Leistriz engineering for your application.		

# TWIN DIRECT/TELESCOPIC PASSENGER

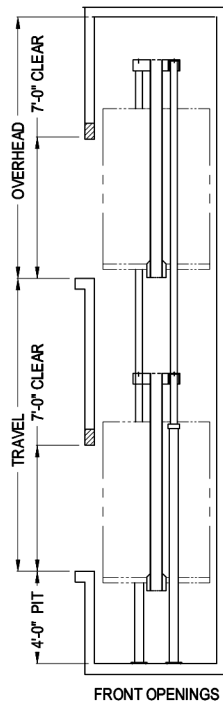

FRONT OPENINGS

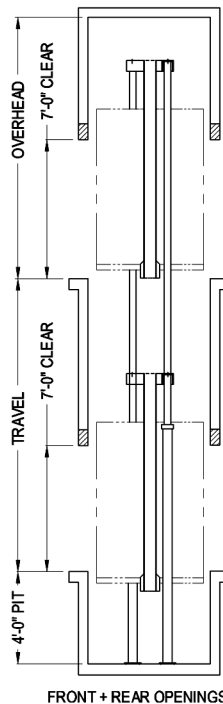

FRONT + REAR OPENINGS

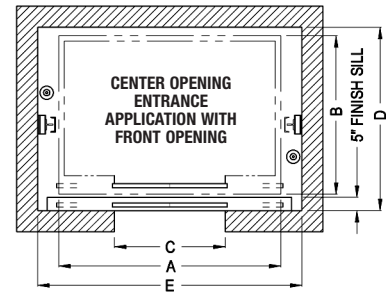
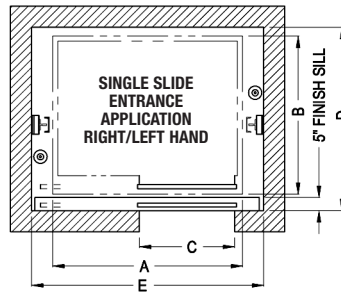
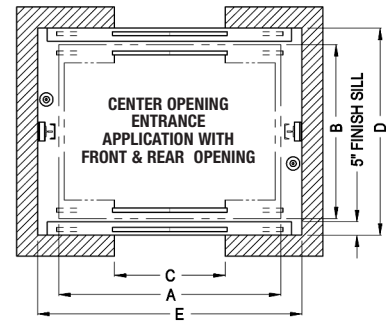
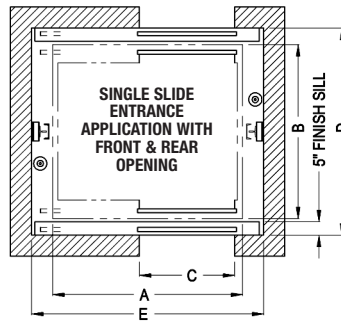

## SPECIFICATIONS: TWIN DIRECT/TELESCOPIC PASSENGER

Type	Twin Direct/Telescopic Front Opening Only/Front & Rear Opening							
Service	Passenger							
Speed	80 FPM, 100 FPM, 125 FPM, 150 FPM							
Capacity	2000 lb		2500 lb		3000 lb		3500 lb	
Clear Car Size	5'-8" x 4'-3"		6'-8" x 4'-3"		6'-8" x 4'-9"		6'-8" x 5'-5"	
Opening	Front	F & R	Front	F & R	Front	F & R	Front	F & R
A	6'-0"	6'-0"	7'-0"	7'-0"	7'-0"	7'-0"	7'-0"	7'-0"
B	5'-0"	5'-6"	5'-0"	5'-6"	5'-6"	6'-0"	6'-2"	6'-8"
C	3'-0"	3'-0"	3'-6"	3'-6"	3'-6"	3'-6"	3'-6"	3'-6"
D	5'-9"	6'-6 1/2"	5'-9"	6'-6 1/2"	6'-3"	7'-0 1/2"	6'-11"	7'-8 1/2"
E	Travel and capacity dependent							
Pit	4'-0" Standard							
Overhead	Travel dependent, consult Leistriz engineering with questions.							
Machine Room	7'-0" x 5'-0" x 7'-6" Machine room may vary. Consult Leistriz engineering with questions							
Entrance Types	Single Slide (Left or Right) Center Opening (Not available for 2000 lb Capacity)							
Travel	Up to 30 ft., consult Leistriz engineering for your application.							

# Leistriz

Leistriz Corporation, 165 Chestnut Street, Allendale, NJ 07401  
(201) 934-8262 • Fax: (201)934-8266 • www.leistrizcorp.com